

# CERTIFICATE OF THE RESPONSIBLE DESIGNER

Section 94  
Section 106  
Section 129  
Section 155

Form **35**

To:  Owner name  
 Address  
  Suburb/postcode

## Designer details:

Name:  Category:   
 Business name:  Phone No:   
 Business address:   
  Fax No:   
 Licence No:  Email address:

## Details of the proposed work:

Owner/Applicant  Designer's project reference No.   
 Address:   
  Lot No:   
 Type of work: Building work  Plumbing work  (X all applicable)

## Description of work:

LevelMaster Generic Stair Stringers

(new building / alteration / addition / repair / removal / re-erection  
 water / sewerage / stormwater / on-site wastewater management system / backflow prevention / other)

## Description of the Design Work (Scope, limitations or exclusions): (X all applicable certificates)

Certificate Type:	Certificate	Responsible Practitioner
	<input type="checkbox"/> Building design	Architect or Building Designer
	<input checked="" type="checkbox"/> Structural design	Engineer or Civil Designer
	<input type="checkbox"/> Fire Safety design	Fire Engineer
	<input type="checkbox"/> Civil design	Civil Engineer or Civil Designer
	<input type="checkbox"/> Hydraulic design	Building Services Designer
	<input type="checkbox"/> Fire service design	Building Services Designer
	<input type="checkbox"/> Electrical design	Building Services Designer
	<input type="checkbox"/> Mechanical design	Building Service Designer
	<input type="checkbox"/> Plumbing design	Plumber-Certifier; Architect, Building Designer or Engineer
	<input type="checkbox"/> Other (specify)	

Deemed-to-Satisfy:  Performance Solution:  (X the appropriate box)

## Other details:

LevelMaster Generic Stair Stringers system for the State of Tasmania

<b>Design documents provided:</b>	
-----------------------------------	--

The following documents are provided with this Certificate –

*Document description:*

Drawing numbers:	Prepared by:	Date:
PCE2247.3 – Rev 0	PEERCE	MAY 2023
Schedules:	Prepared by:	Date:
Specifications:	Prepared by:	Date:
Design Certification - LEVELMASTER – Stair Stringers	PEERCE	01/05/2023
Computations:	Prepared by:	Date:
Performance solution proposals:	Prepared by:	Date:
Test reports:	Prepared by:	Date:

<b>Standards, codes or guidelines relied on in design process:</b>	
--	--

NCC 2022 Building Code of Australia  
AS 1170.0 2002 Structural design action – General principals  
AS 1170.1 2002 Permanent, Imposed and Other Actions  
AS 1170.2 2021 Structural Design Actions – Wind Actions  
AS 4100 2020 Steel Structures

<b>Any other relevant documentation:</b>	
--	--

<b>Attribution as designer:</b>	
---------------------------------	--

I, Mengting Zhao, am responsible for the design of that part of the work as described in this certificate;

The documentation relating to the design includes sufficient information for the assessment of the work in accordance with the *Building Act 2016* and sufficient detail for the builder or plumber to carry out the work in accordance with the documents and the Act;

This certificate confirms compliance and is evidence of suitability of this design with the requirements of the National Construction Code.

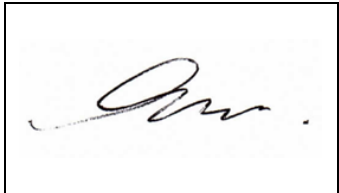
	<i>Name: (print)</i>	<i>Signed</i>	<i>Date</i>
Designer:	Mengting ZHAO		01/05/2023 This certificate expires on 30/04/2024
Licence No:	PE0005236		

**Assessment of Certifiable Works: (TasWater)**

**Note: single residential dwellings and outbuildings on a lot with an existing sewer connection are not considered to increase demand and are not certifiable.**  
**If you cannot check ALL of these boxes, LEAVE THIS SECTION BLANK.**  
**TasWater must then be contacted to determine if the proposed works are Certifiable Works.**

**I confirm that the proposed works are not Certifiable Works, in accordance with the Guidelines for TasWater CCW Assessments, by virtue that all of the following are satisfied:**

- The works will not increase the demand for water supplied by TasWater
- The works will not increase or decrease the amount of sewage or toxins that is to be removed by, or discharged into, TasWater's sewerage infrastructure
- The works will not require a new connection, or a modification to an existing connection, to be made to TasWater's infrastructure
- The works will not damage or interfere with TasWater's works
- The works will not adversely affect TasWater's operations
- The work are not within 2m of TasWater's infrastructure and are outside any TasWater easement
- I have checked the LISTMap to confirm the location of TasWater infrastructure
- If the property is connected to TasWater's water system, a water meter is in place, or has been applied for to TasWater.

**Certification:**

I ..... being responsible for the proposed work, am satisfied that the works described above are not Certifiable Works, as defined within the *Water and Sewerage Industry Act 2008*, that I have answered the above questions with all due diligence and have read and understood the Guidelines for TasWater CCW Assessments.

Note: the Guidelines for TasWater Certification of Certifiable Works Assessments are available at: [www.taswater.com.au](http://www.taswater.com.au)

	<i>Name: (print)</i>	<i>Signed</i>	<i>Date</i>
Designer:	<input type="text"/>	<input type="text"/>	<input type="text"/>

# GENERAL NOTES

- 1 THESE DRAWINGS SHALL BE READ IN CONJUNCTION WITH ALL ARCHITECTURAL AND OTHER CONSULTANTS DRAWINGS, SPECIFICATIONS AND WITH SUCH OTHER WRITTEN INSTRUCTIONS AS MAY BE ISSUED DURING THE COURSE OF THE CONTRACT. ALL DISCREPANCIES SHALL BE REFEREED TO THE SUPERVISING OFFICER FOR DECISION BEFORE PROCEEDING WITH THE WORK.
- 2 NO RESPONSIBILITY WILL BE TAKEN BY THE CONSULTING ENGINEER FOR DIMENSIONS OBTAINED BY SCALING THE STRUCTURAL DRAWINGS.
- 3 ALL DIMENSIONS SHALL BE VERIFIED ON SITE BY THE CONTRACTOR WHO SHALL BE RESPONSIBLE FOR THEIR CORRECTNESS. ALL DIMENSIONS IN THESE DRAWINGS ARE APPROXIMATE AND ARE FOR THE SOLE PURPOSE OF ASSISTING THE STRUCTURAL DOCUMENTATION.
- 4 THE CONTRACTOR SHALL BE RESPONSIBLE FOR MAINTAINING THE STRUCTURE AND NEIGHBOURING STRUCTURES IN A SAFE AND STABLE CONDITION DURING CONSTRUCTION. NO PART SHALL BE OVERSTRESSED.
- 5 ALL MATERIALS AND WORKMANSHIP SHALL BE IN ACCORDANCE WITH THE REQUIREMENTS OF THE CURRENT S.A.A. CODES AND THE BY-LAWS AND ORDINANCES OF THE RELEVANT GOVERNMENT AUTHORITY.
- 6 HANDRAILS AND FIXINGS SHALL BE DESIGNED AND INSTALLED TO RESIST LOADS TO AS1170 WITH STRUCTURAL ENGINEERING CERTIFICATION SUPPLIED BY THE MANUFACTURER.
- 7 PROPRIETARY ITEMS SHALL BE INSTALLED IN STRICT ACCORDANCE WITH THE MANUFACTURER'S SPECIFICATION.

# STRUCTURAL STEELWORK NOTES

- S1 ALL WORKMANSHIP AND MATERIALS SHALL BE IN ACCORDANCE WITH AS 4100.
- S2 ALL MEMBERS TO BE HOT DIPPED GALVANISED OR DURAGAL WITH ALL WELDS TO BE COLD GAL TREATED.

*RHS STRINGERS PER TREAD AMOUNT	
STRINGER MATERIAL	No. OF TREADS PER STRINGER SET
100x50 RHS 3.0	1 - 10 TREADS
125x75 RHS 3.0	11 - 14 TREADS
125x75 RHS 5.0	15 - 17 TREADS
ALL STRINGERS PLACED AT 1000mm CRS. MAX.	

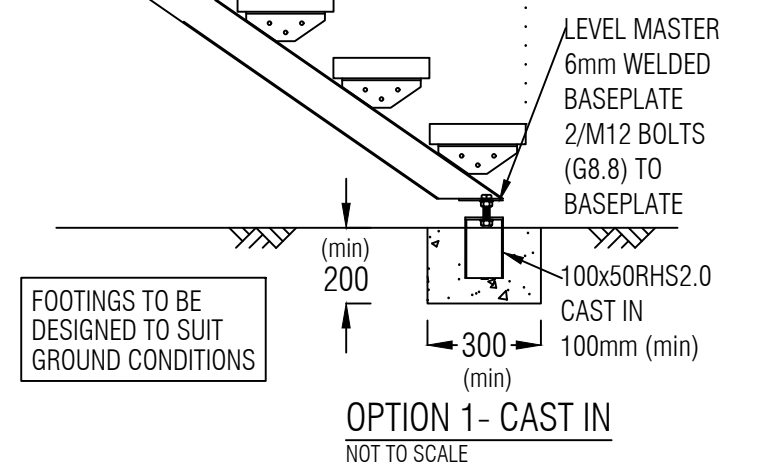
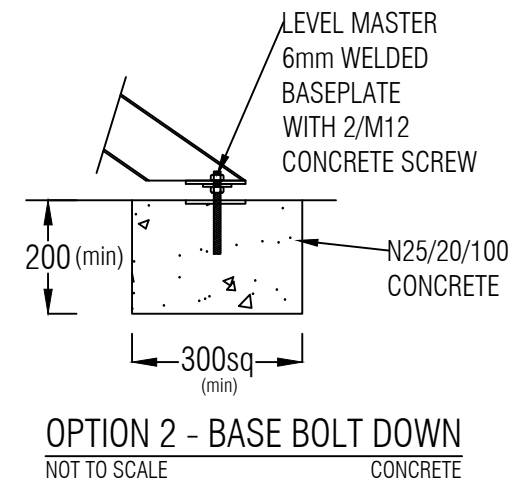
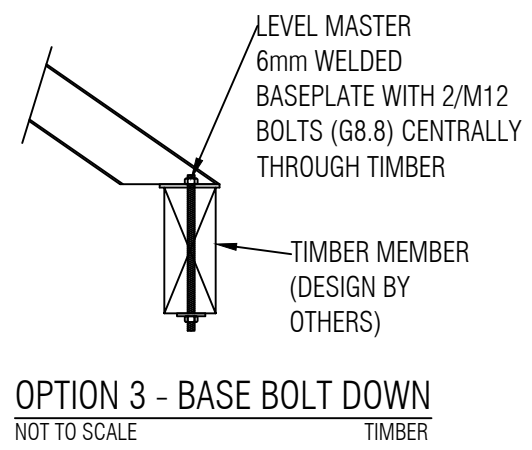
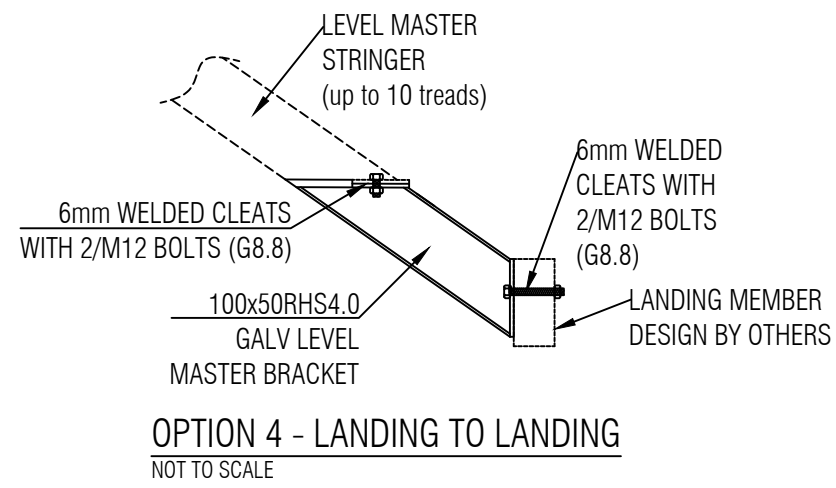
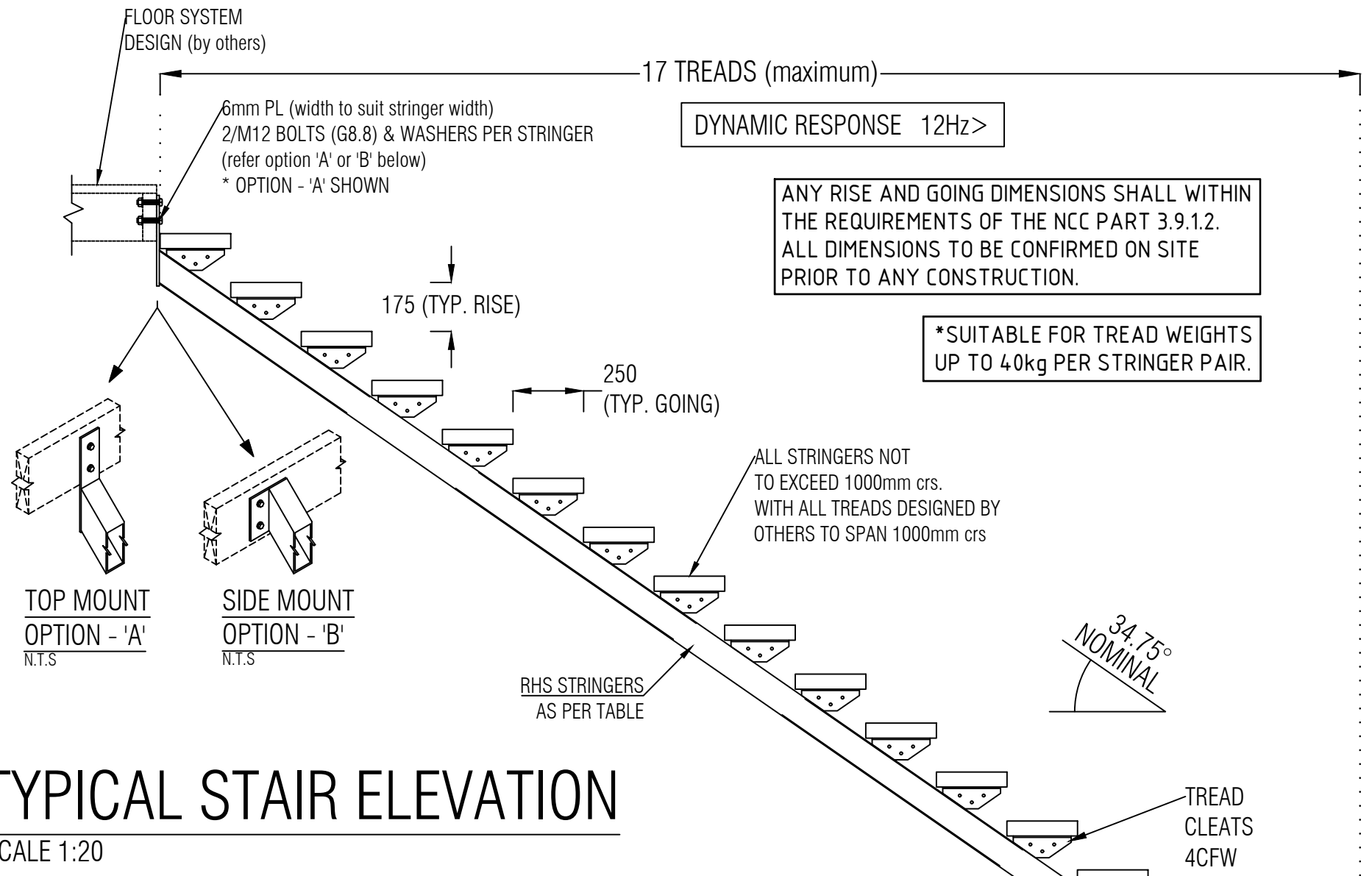

DO NOT SCALE FROM DRAWING  
ALL SCALES ARE AS SHOWN (A3)

\*ORIGINAL DATA PROVIDED BY SUMMERMORE Pty Ltd.

REV.	DESCRIPTION	DATE	INIT.
A	PRELIMINARY ISSUE	MAY2023	J.L.
0	FOR CERTIFICATION	MAY2023	J.L.

**PEER Consulting Engineers**  
Professional Economical Efficient Reputable

CONTACT DETAILS  
EMAIL info@peerce.com.au  
WEB www.peerce.com.au  
PHONE 07 3841 2046  
POST 4B/2404 LOGAN RD, EIGHT MILE PLAINS QLD 4113

CLIENT  
**LEVEL MASTER**

PROJECT  
**GENERIC STAIR STRINGERS**

TITLE  
**STAIR ELEVATION & STRINGERS TABLE**

DRAWN	DESIGNED	DATE
J.L.	-	MAY 2023
CHECKED	APPROVED	
N.Z.		
DRAWING No.	REV.	
PCE2247.3 - S01	0	