

BRACING NOTES

- 1
- THREAD HEIGHT MEASURED FROM TOP OF NUT TO UNDERSIDE OF FIXING TOP PLATE.
- 2
- CAST IN COLUMNS MAY HAVE CAPACITIES THAT EXCEED THOSE IN TABLE-1 BELOW. THIS IS TO BE CONFIRMED AND DESIGNED BY THE PROJECT ENGINEER.
- 3
- BRACING ANGLES IN EXCESS OF 45° MAY REQUIRE ADDITIONAL HORIZONTAL BRACING. THIS IS TO BE DESIGNED BY THE PROJECT ENGINEER.
- 4
- BRACING MAY BE FIXED TO BEARERS. THIS IS TO BE DESIGNED BY THE PROJECT ENGINEER TO SUIT THE BEARER BEING USED.

ALL SCREWS TO BE CLASS 4
12g (24TPI) FROM ICCONS PTY LTD.

ALL STEEL TO BE G250 (U.N.O).

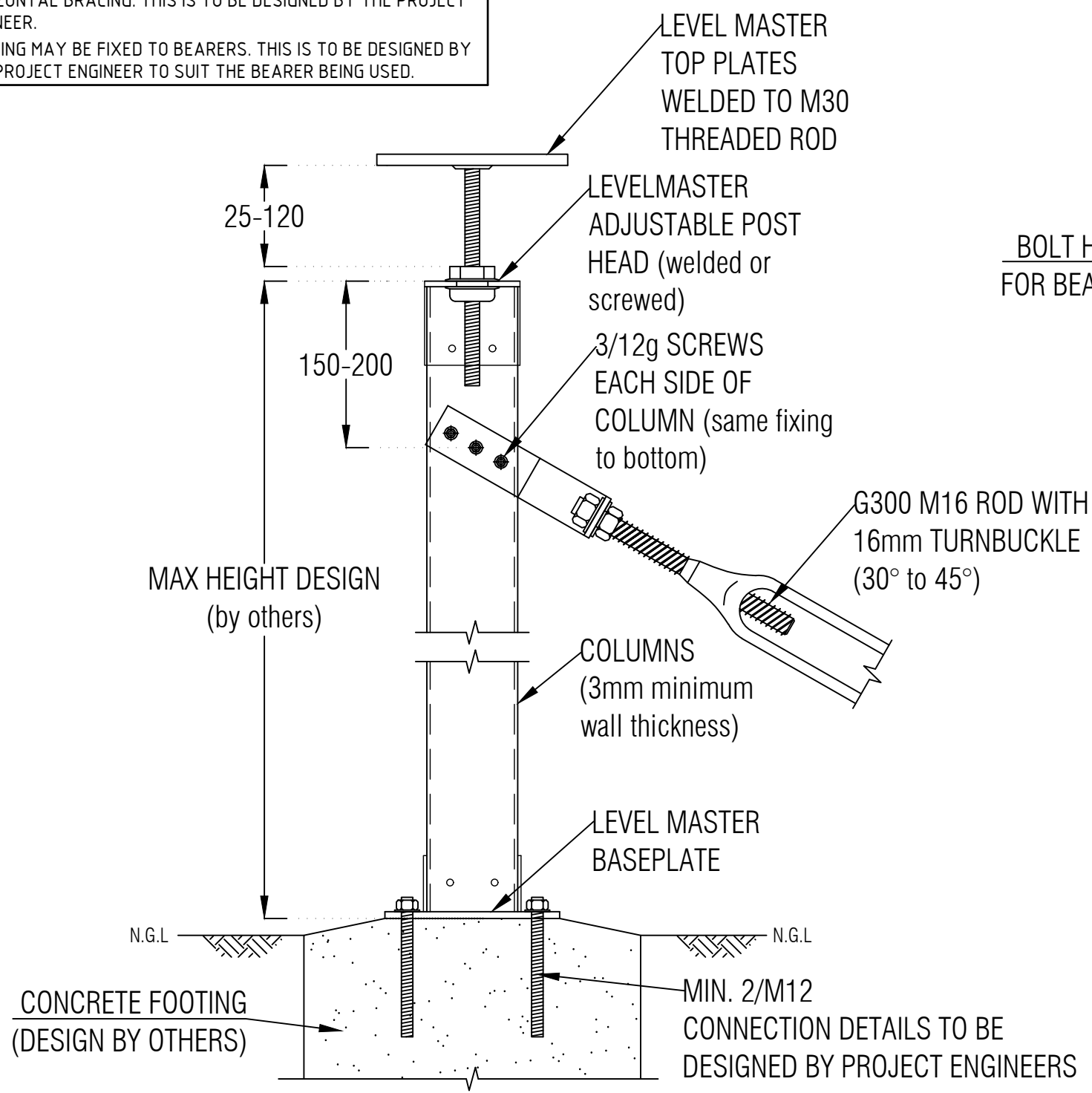

TYPICAL BRACING SECTION
N.T.S

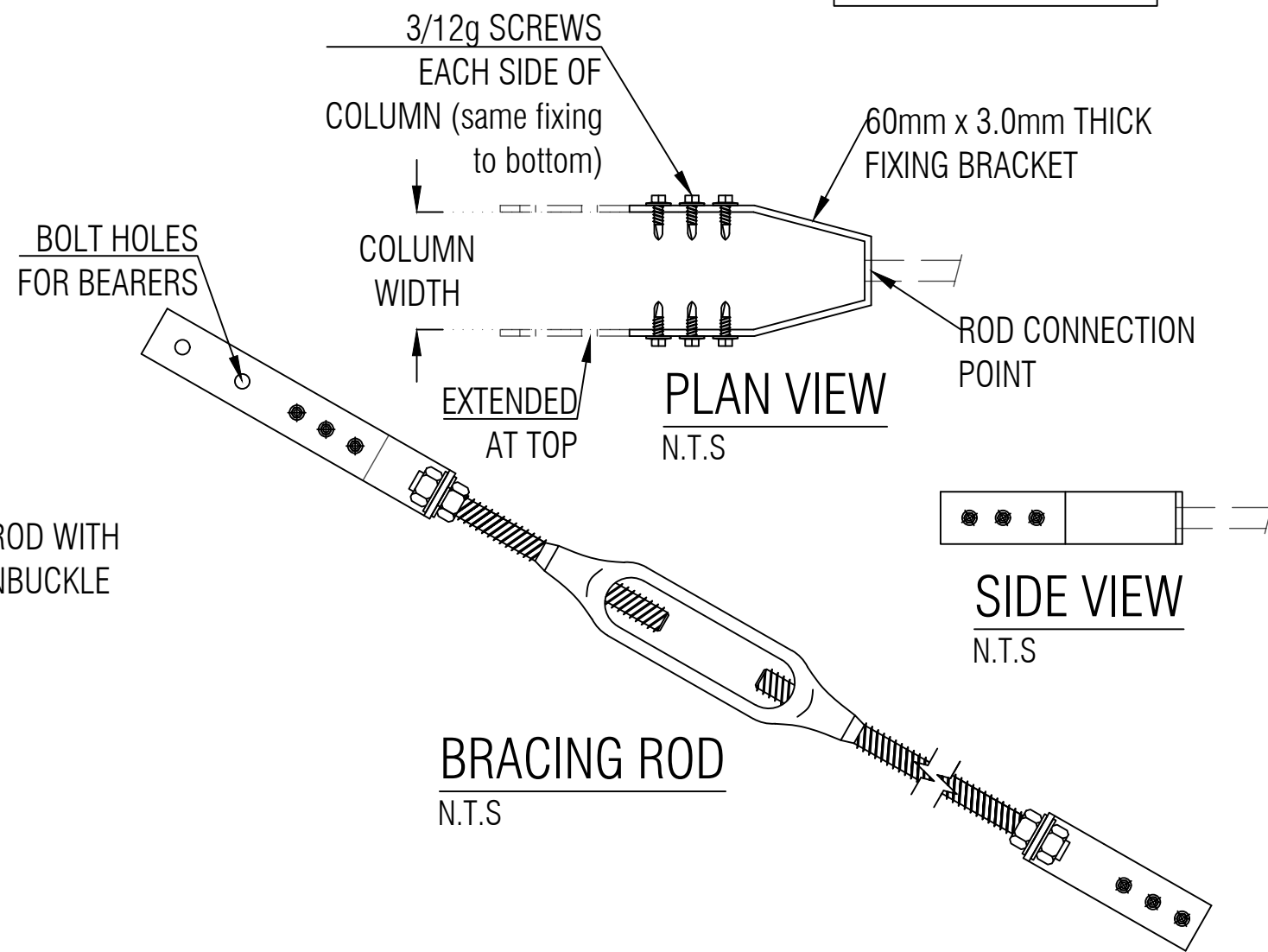

BRACING ROD
N.T.S

| *TABLE-1 | |
|---|---|
| M16 BRACING CAPACITIES (M30 THREAD EXTENSION) | |
| THREAD HEIGHT (mm) | RACKING CAPACITY FOR CROSS BRACING SET (kN) |
| 25 | 27.0 |
| 50 | 27.0 |
| 75 | 26.6 |
| 100 | 20.0 |
| 120 | 17.5 |

DO NOT SCALE FROM DRAWING
ALL SCALES ARE AS SHOWN (A3)

*ORIGINAL DATA PROVIDED BY SUMMERMORE Pty Ltd.

| REV. | DESCRIPTION | DATE | INIT. | <div> PEER Consulting Engineers <small>Professional Economical Efficient Reputable</small></div> | CONTACT DETAILS | CLIENT | PROJECT | TITLE | DRAWN | DESIGNED | DATE | |
|------|-------------------|---------|-------|--|-----------------|--|--------------|-------------------------|-------------------------|-----------------|----------|----------|
| A | PRELIMINARY ISSUE | MAY2023 | J.L. | | EMAIL | info@peerce.com.au | LEVEL MASTER | TYPICAL ROD BRACING SET | ROD BRACING CONNECTIONS | J.L. | - | MAY 2023 |
| 0 | FOR CERTIFICATION | MAY2023 | J.L. | | WEB | www.peerce.com.au | | | | CHECKED | APPROVED | |
| | | | | | PHONE | 07 3841 2046 | | | | N.Z. | | |
| | | | | | POST | 4B/2404 LOGAN RD, EIGHT MILE PLAINS | | | | DRAWING No. | REV. | |
| | | | | | | QLD 4113 | | | | PCE2247.2 – S01 | 0 | |
| | | | | | | | | | | | | |